



ELEVATION

CONSTRUCTION:
Fabricated aluminum channel letters, Frutiger Medium typeface,
internally illuminated with White LEDs.

Abc Donorxxxx
Neurosciences Center
107.67 Sq.Ft.

A Black

ONE (1) SET OF INTERNALLY-ILLUMINATED EXTERIOR LETTERS

Scale: 3/8" = 1'-0"

SIGNgraphix

39255 Country Club Drive, Suite B-35,
Farmington Hills, Michigan 48331-3490
Ph: 248-848-1700 Fax 248-848-1722
www.signgraphix.net

St. John Hospital Van Elslander Neurosciences

47601 Grand River Novi, MI 48374

DRAWING: 3-13-09
14210
JOB: 17053

CLIENT SIGNATURE

DATE

These designs, details and plans represented herein are the property of SignGraphix, Inc. specifically developed for your personal use in connection with the project being planned for you by SignGraphix, Inc. It is not to be shown to anyone outside your organization, nor is it to be used, reproduced, exhibited or copied in any fashion whatsoever all any part of this design (excepting registered trademarks) remain the property of SignGraphix, Inc.

Day light simulation

Abc Donorxxxx
Neurosciences Center

Night simulation option A - Black/White acrylic faces

Abc Donorxxxx
Neurosciences Center

Night simulation option B - halo silhouette lighting

Abc Donorxxxx
Neurosciences Center

Perspective rendering



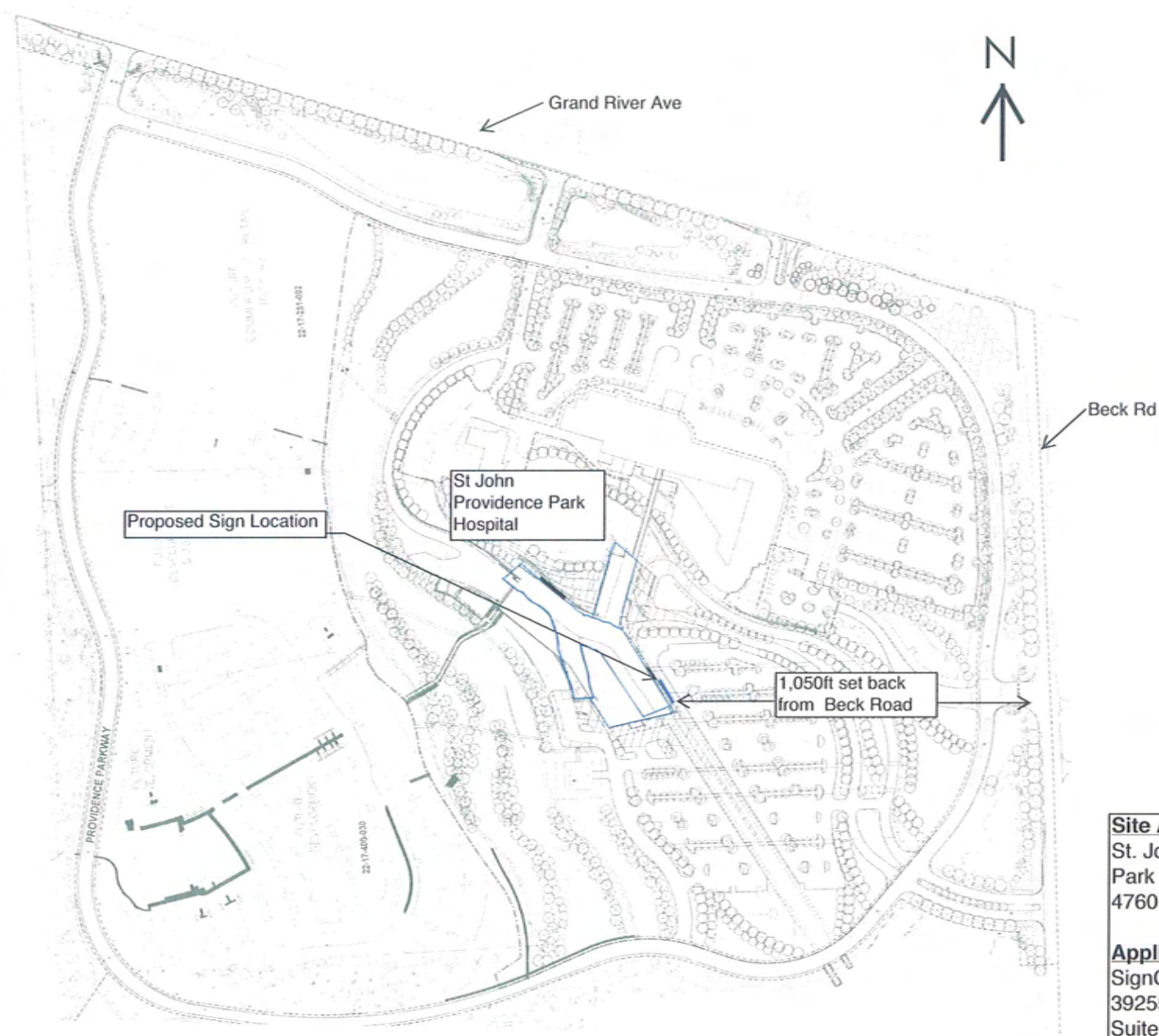

Site Address:
St. John Providence
Park Hospital
47601 Grand River Ave.

Applicant:
SignGraphix, Inc.
39255 Country Club Drive
Suite B-35
Farmington Hills, MI 48331