

ZONING BORD OF APPEALS

NORTHERN EQUITIES GROUP

LOCATION: 39475 LEWIS DRIVE, SUITE 110

9. The Lewis Medical Office Centre is 45,870 square feet which is 9% short of the required 50,000 square feet in order to include a pharmacy. It is impossible to enlarge the building to make it 4,130 square feet larger. A number of our tenants have respectfully asked that we have a pharmacy in the building to provide this service to their patients.

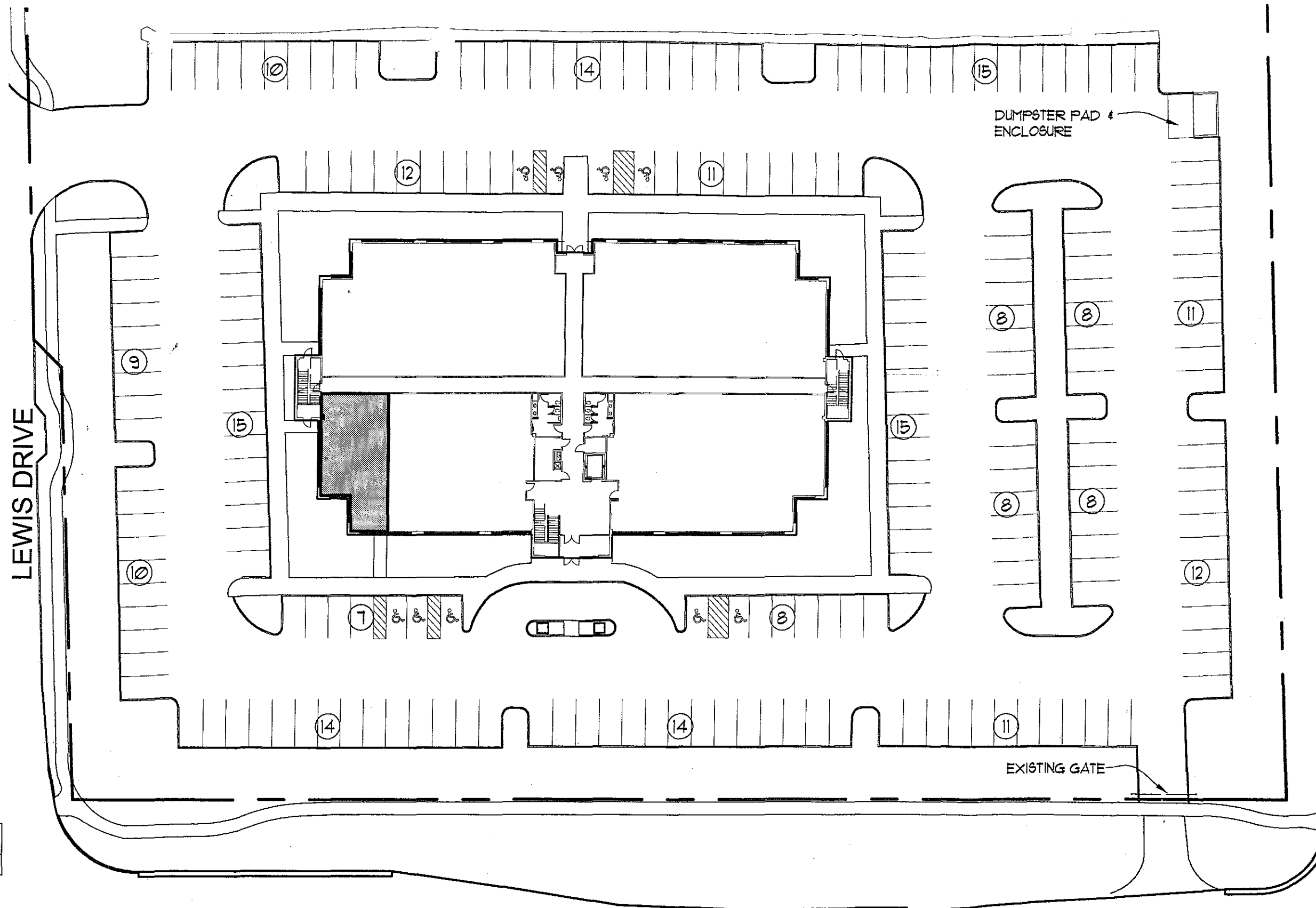

EXISTING SITE PLAN

SCALE: N.T.S.

HAGGERTY ROAD

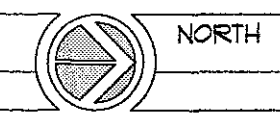

NORTH

SEAL

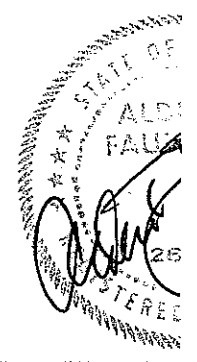

REV	DATE	ISSUED FOR
	4-20-10	BUILDING
	12-23-09	OWNER /

DRAWN BY:	BLL
CHECKED BY:	BLL
IN CHARGE:	ALF
CAD DWG. FILE:	G-000 (0

This drawing as an instrument of service of Faudie Architecture, Inc. Any unauthorized use is prohibited without the written consent of Faudie Architecture, Inc.

DRAWING DATE:	6-15-10
---------------	---------

SHEET TITLE
PROJECT TITLE

JOB NO.:	09049
----------	--------------