

SCALE: 1:2

PROPOSED SIGN LAYOUT NORTH BUILDING FACE

NAVY BLUE BACKGROUND
COLLEX = WHITE COLLISION EXPERTS = RED

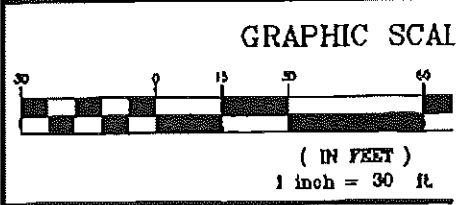
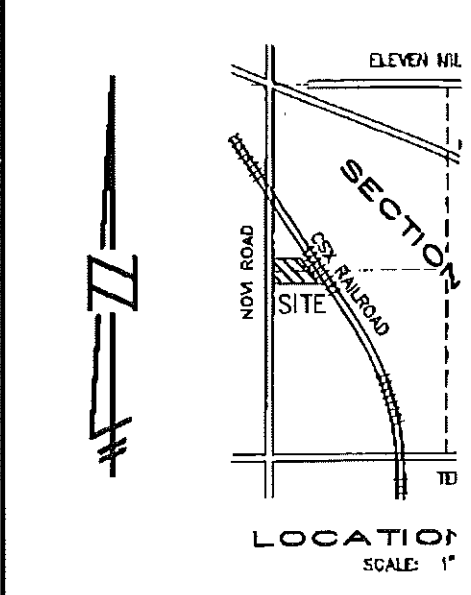
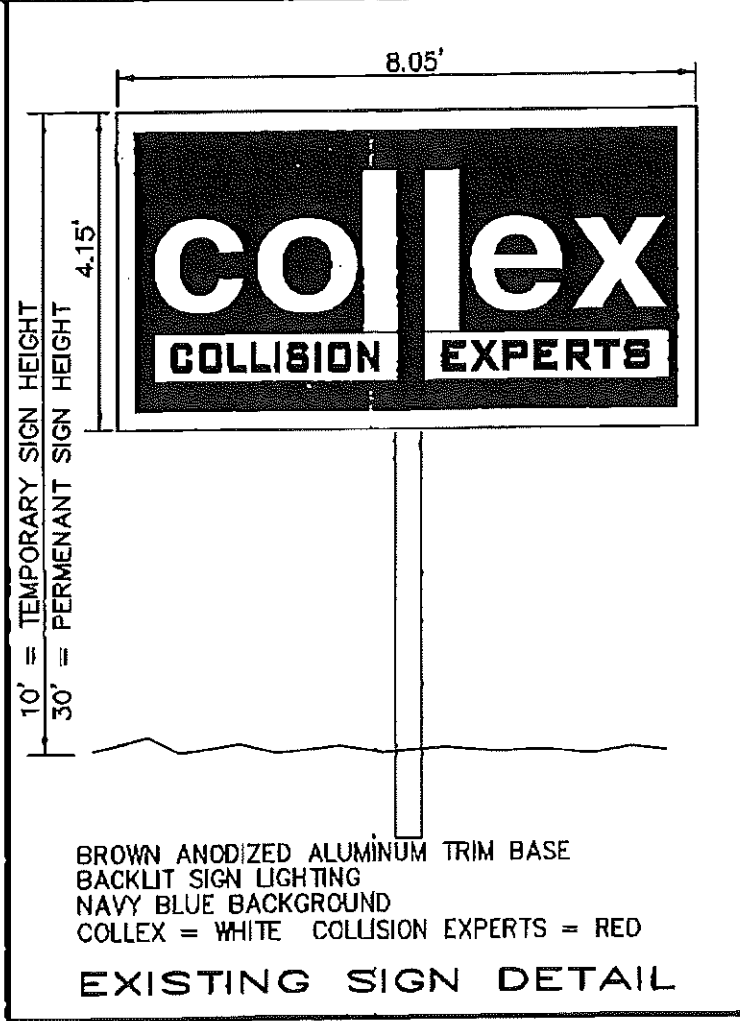
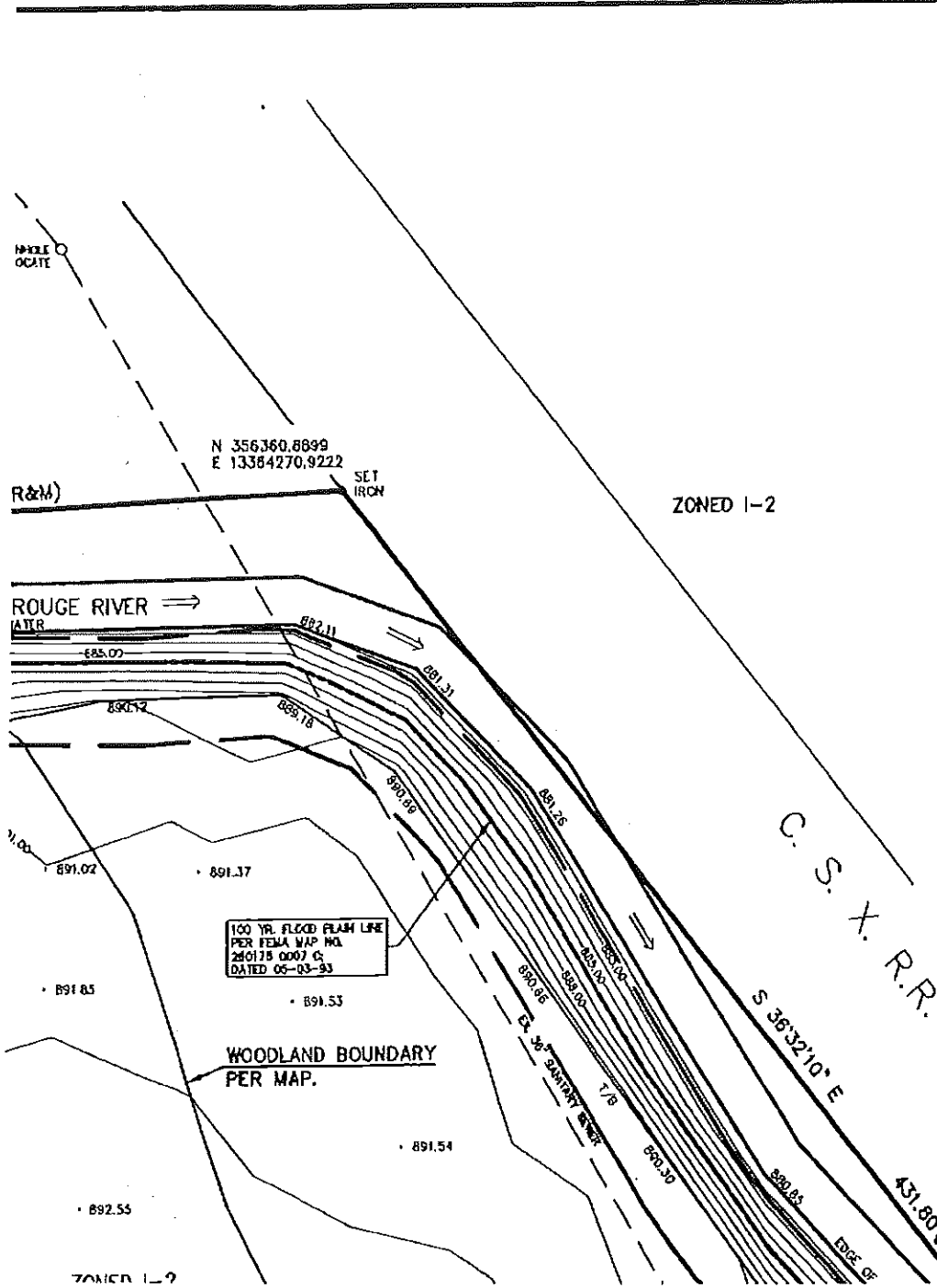

Subject Property
Legal Description (SIDWELL NO. 50-22-2)

A part of the West 1/2 of Section 23, East, City of Novi, Oakland County, Michi particularly described as commencing at of said Section 23 for the Point of Begi North, 177.45 feet, along the West line of the centerline of Novi Road (60.00 foot thence North 89°39'00" East, 416.78 feet; 36°32'10" East, 431.80 feet; thence North 00°01'23" West, 164.45 feet, along the W 23 and the centerline of said Novi Road Beginning. All of the above containing the above being subject to easements, right-of-ways of record. All of the abri the rights of the public in Novi Road. Gross Land Area 4.327 Acres

SOIL INFORMATION
PER THE SOIL CONSERVATION SERVICES OAKLAND COUNTY AREA AREA, MICHIGAI (DRI AND RESSIED) JULY 2001. THE SI