



**CITY OF NOVI CITY COUNCIL
JUNE 5, 2023**

SUBJECT: Consideration of approval to award the contract to Nature Playscapes, a uniquely qualified company, for the construction of Northwest Park Playground, in the amount of \$99,968.21.

SUBMITTING DEPARTMENT: Parks, Recreation and Cultural Services

EXPENDITURE REQUIRED	\$ 99,968.21
AMOUNT BUDGETED	\$ 100,000 (FY 2023-24 Budget)
APPROPRIATION REQUIRED	\$ 0
LINE ITEM NUMBER	208-752.00-977.033

BACKGROUND INFORMATION:

In 2015, the City of Novi acquired nearly 10 acres of property on Twelve Mile Road, southwest of Napier Road. The property was designated as parkland in 2017. Following input sessions with the community, and specifically the adjacent Andelina Ridge neighborhood, the city applied for and received a grant from Oakland County Parks and Recreation in 2022 in the amount of \$100,000 for the development of the park. In addition to the proposed playground, design is currently underway for pathways throughout the park. A parking lot was constructed in 2022.

The proposed playground is of a nature-based design, something new to the Novi Parks system. Using mainly natural materials such as stumps, logs, and boulders, the playground elements will be custom built for the park. Natural materials have a lifespan similar to those made with synthetic materials and ease of "part" replacement is made simpler. This type of construction also introduces the opportunity to source border and retain materials locally. Elements have been chosen to promote inclusivity for those with differing abilities and ages. The playground will be constructed in a wooded area of the park. With the likelihood of tree debris (branches, acorns, leaves, etc.) routinely falling or blowing into the playground area, engineered wood fiber is the planned surfacing material. The playground concept was supported by the PRCS Commission at the April 20, 2023, meeting.

Nature Playscapes playgrounds are designed and constructed with industry standards for public playground safety and inclusivity. The Nature Playscapes team includes a design team and a landscape construction manager that focuses on using a variety of natural materials, textures and surfaces that encourages unstructured play. Each playground is custom designed, with elements built onsite, based on the needs and wants of the community. The Children's Nature Playscape on Bronson Park in Kalamazoo is a similar example.

Images of the proposed design elements are attached. The contract would be effective after July 1, 2023, with construction anticipated for late fall 2023.

RECOMMENDED ACTION: Consideration of approval to award the contract to Nature Playscapes, a uniquely qualified company, for the construction of Northwest Park Play Structure, in the amount of \$99,968.21.



ESTIMATE

Nature Playscapes LLC
 PO Box 424
 Oshtemo, Michigan 49077
 United States

Mobile: (269) 598-5383
www.NaturePlayscapes.com

BILL TO
City of Novi
 Tracie Ringle
 45175 Ten Mile Rd
 Novi, Michigan 48375
 United States

248-735-5613
tringle@cityofnovi.org

Estimate Number: 104
Estimate Date: April 18, 2023
Expires On: May 18, 2023

Grand Total (USD): \$99,968.21

Services	Quantity	Rate	Amount
Project Mobilization, Site Preparation and Staging Includes removal of undesirable soils and/or debris within project area	1	\$11,488.03	\$11,488.03
Materials, Labor, Installation - Playscape Components Embankment Slide Access and Hobbit Cave - to be prepared as per plan with inorganic base material and compacted crushed aggregate over geosynthetic fabric. Outcropping stone will be installed and lined with filter fabric to prevent washout. Hobbit cave will be incorporated into the berm which will be constructed to provide access to upper embankment slide	1	\$8,800.93	\$8,800.93
Materials, Labor, Installation - Playscape Components Embankment Slide	1	\$10,923.28	\$10,923.28
Materials, Labor, Installation - Playscape Components Stump Tower	1	\$8,490.23	\$8,490.23
Materials, Labor, Installation - Playscape Components Amorphous Log	1	\$9,155.48	\$9,155.48
Materials, Labor, Installation - Playscape Components Vertical Rock Climber	1	\$12,024.52	\$12,024.52
Materials, Labor, Installation - Playscape Components Play Area Borders and Bench Logs	1	\$14,130.14	\$14,130.14



ESTIMATE

Nature Playscapes LLC
 PO Box 424
 Oshtemo, Michigan 49077
 United States

Mobile: (269) 598-5383
www.NaturePlayscapes.com

Services	Quantity	Rate	Amount
Materials, Labor, Installation - Playscape Safety Certified Engineered Wood Fiber Surfacing and Safety Warning Signage	1	\$6,767.25	\$6,767.25
Nature Playscape Project Allowance for freight charges (expected fees per proposed design)	1	\$4,000.00	\$4,000.00
Materials, Labor, Installation - Playscape Components Hanging Parallel Balance Beams	1	\$8,794.85	\$8,794.85
Materials, Labor, Installation - Playscape Components Wacky Posts (softwoods), set of 5	1	\$5,393.50	\$5,393.50
Total:			\$99,968.21
Grand Total (USD):			\$99,968.21

Notes / Terms

OUR TEAM

Nature Playscapes, in collaboration with Only Outdoor Living, is pleased to present a proposal for conceptual design, creation and construction of a nature playscape to support youth development, sensory stimulation and exploration.

Our team proposes a design-build process which includes a layout of play components promoting optimal safety and circulation patterns, low maintenance, age-appropriate play components and risk managed installation methods.

Nature Playscapes has assembled a team bringing experience, insight, and is exceptionally well qualified experience to identify components and project requirements for the proposed space; develop a design that aligns with the goals and vision of the client, prepare documents which will serve as the basis for construction, and properly install and construct the designed play area. Specific expertise in planning and design, barrier-free and inclusive design guidelines, cost opinion development, native planting design, and green infrastructure solutions will be available by the following team leaders:

Tricia Keala, CPSI, CPRP is the Co-Founder of Nature Playscapes, a Kalamazoo based small business which is minority and female owned and operated. Tricia recommends best practice principles utilizing applicable industry standards such as ASTM, CPSC, OSHA, ADA, etc. Particularly in non-traditional play settings such as this, it is critical to identify acceptable risk levels and to assess materials, design layouts, evaluate components and specify installation methods which will produce a safe play area for children, limit liability for the owner and create engaging learning environments. Tricia offers nearly 20 years of risk management experience in the recreation setting and 15 years as a Certified Playground Safety Inspector.

AMORPHOUS LOG



HANGING BALANCE BEAMS



EMBANKMENT SLIDE



VERTICAL ROCK CLIMBER



STUMP TOWER



WHACKY POSTS



SAWN LOG BENCH/BORDER



GENERAL CONSTRUCTIONS NOTES:

- ELEVATED PLAY COMPONENTS TO ALIGN WITH CPSC AND ASTM F1487 STANDARDS FOR PUBLIC PLAYGROUND SAFETY
- USE ZONE SURFACING TO COMPLY WITH ASTM F1292 STANDARD FOR PUBLIC PLAYGROUND SAFETY SURFACING

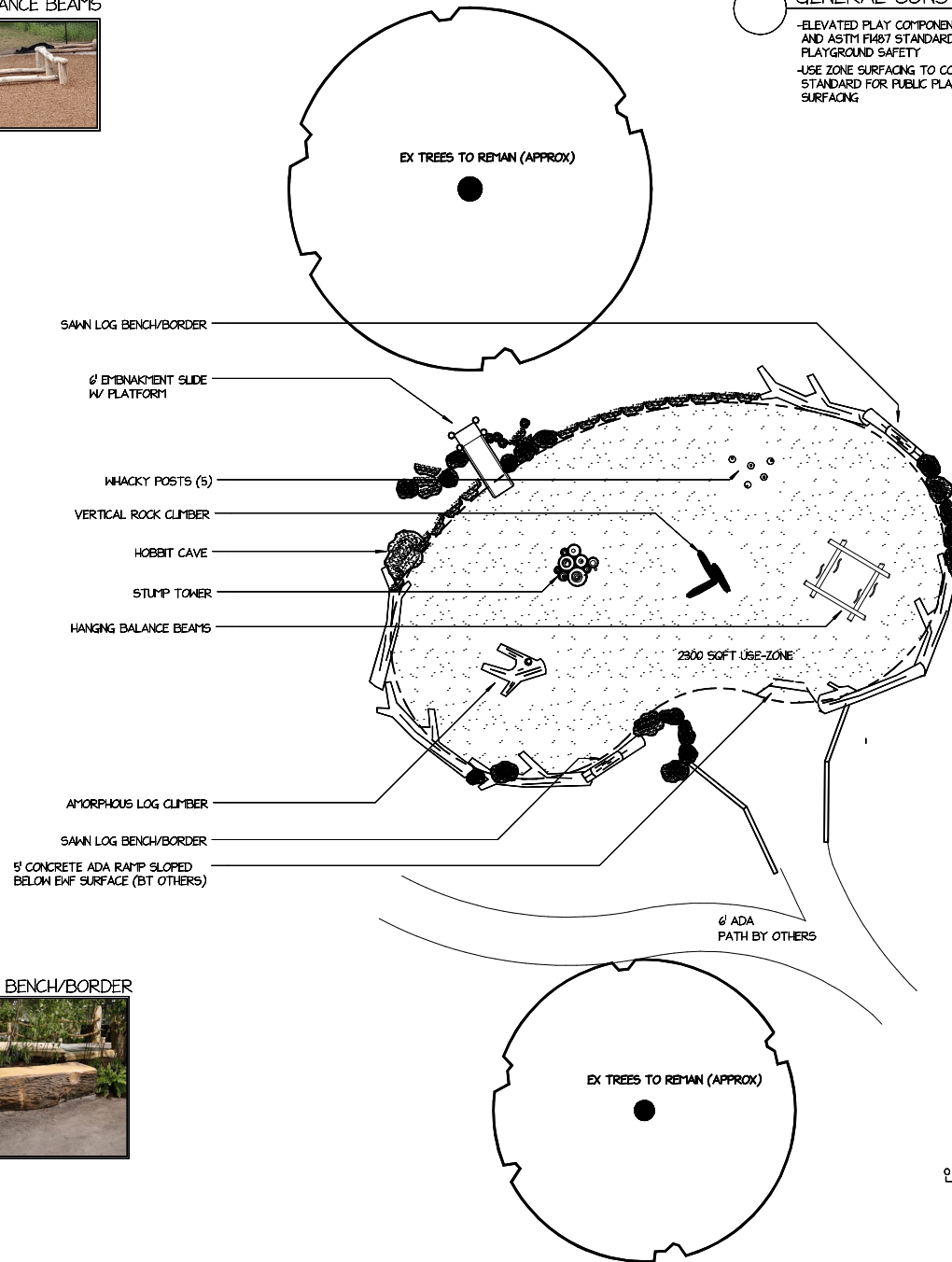

NORTH