



CITY of NOVI CITY COUNCIL

Agenda Item L
July 31, 2017

SUBJECT: Approval to make the award for the Fuerst Sisters Wing upgrades to Great Lakes Power and Lighting INC, the City's contracted Electrical contractor, in the amount of \$38,738.51 for lighting upgrades and Continental Flooring Company, based on IGPA cooperative purchasing contract, in the amount of \$34,330 for flooring upgrades.

SUBMITTING DEPARTMENT: Integrated Solutions Team- Facilities Management

CITY MANAGER APPROVAL: 

EXPENDITURE REQUIRED	\$ 73,068.51
AMOUNT BUDGETED	\$ 136,630 FY 2016-17 Budget Rollover
APPROPRIATION REQUIRED	None
LINE ITEM NUMBER	208-691.00-976.039

BACKGROUND INFORMATION:

PRCS, Facilities Management and Finance have worked collaboratively on a plan for improvements in the newly named Fuerst Sisters Wing, including renovation of existing floor, walls, hallways and related lighting in the Community Center area of the building; as well as program supplies (message board, signage and fitness equipment) for use in that area, using the funds as the Fuerst sisters intended. This request is proposing both the lighting and flooring upgrades.

The lighting component will consist of replacing all current florescent lighting with new 2x2 LED fixtures with dimming capabilities in each quarter. This will present a huge cost savings in electric consumption and allow more lighting level options. Great Lakes Power and Lighting, the City's current contracted electrical firm, will be providing all electrical services on this project.

The flooring will be replaced with a new Vinyl Composite Tile (VCT) to add much needed visual enhancement to the programmed space. The proposed flooring is manufactured by Armstrong providing durability with functionality and will provide a clean modern look allowing a state of the art environment for our Citizens and staff. The flooring work will be completed by Continental Flooring Company and their pricing is based on the IGPA Contract cooperative purchasing contract. Contract and product information are attached.

The Facilities Management Division will be providing in-house Construction Management project services and estimate that this project will be completed by late September 2017.

RECOMMENDED ACTION: Approval to make the award for the Fuerst Sisters Wing upgrades to Great Lakes Power and Lighting INC, the City's contracted Electrical contractor, in the amount of \$38,738.51 for lighting upgrades and Continental Flooring Company, based on 1GPA cooperative purchasing contract, in the amount of \$34,330 for flooring upgrades.



9319 North 94th Way • Suite 1000
Scottsdale, AZ 85258
(480) 949-8509 • (800) 825-1221
FAX (480) 945-2603
www.continentalflooring.com

March 20, 2017, 2017

sent via e-mail
bmccullough@cityofnovi.org

Mr. Brandon McCullough
Facilities Manager
City of Novi
45715 W. Ten Mile Road
Novi, MI 48375

**Re: Price quote for VCT and Installation in Four Quarters Center
under our 1GPA Contract #16-01S-01.**

Dear Brandon,

Pursuant to your Request and plans provided, Continental Flooring Company is pleased to submit the following 1GPA Contract Quotation.

City of Novi
Install VCT in Four Quarters Center (per attached drawing)
Novi, MI

In Four Quarters Center, remove and dispose of existing non asbestos VCT (per attached drawing). Prepare concrete subfloor Armstrong "Standard Excelon" Vinyl Composition Tile – Color to be determined (8,640 SF). Cut tight to existing wall base and caulk (350 LF) at all new LVT Areas. Provide and Install Vinyl Transition Strips (72 LF) required for a complete installation.

1GPA Contract Quote Total:..... \$ 34,330.00

The following items were not included in the above price quote:

- Removal of any asbestos containing material
- Waxing or Sealing of VCT
- Furniture Moving
- Excessive floor preparation (exceeding 50 lb per 1,000 SF)
- Bond Costs (if required)
- Pricing based completion with one site mobilization

Should you have any questions or require additional information, please feel free to contact me at steve@continentalflooring.com or (800) 825-1221 ext. 235.

Sincerely,



Steven R. Witkowski
Director of Bidding & Pricing

City of Novi Install VCT in Four Quarters Center

20 March 2017 : City of Novi_Install VCT in Four Quarters Center.est
Novi, MI

Summary Report



Transition CPT/VCT
Base 1 Only
VCT 1 Std

Scale 1:530 (original drawing scale 1:387)

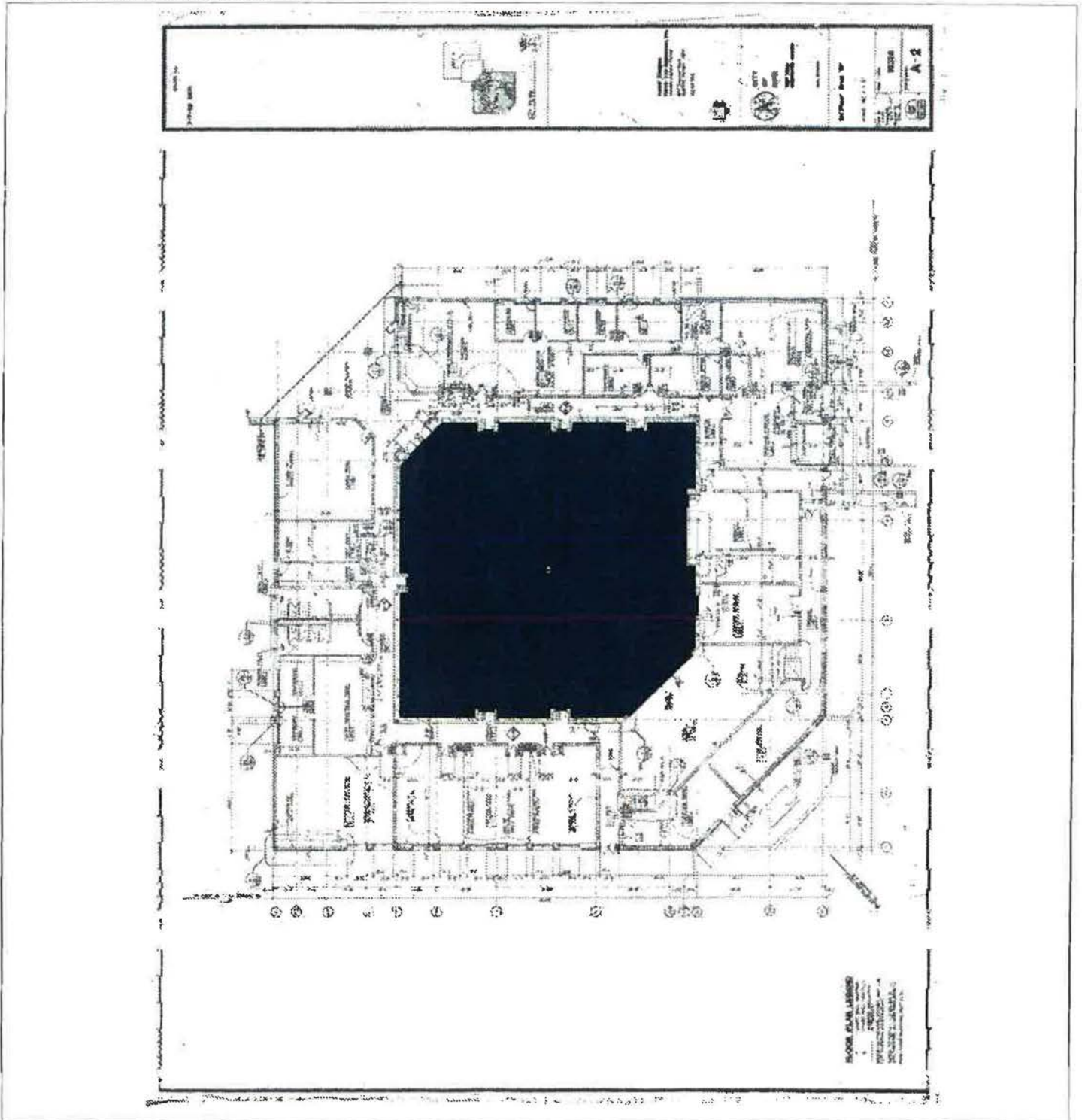



1Government Procurement Alliance

December 17, 2015,

Continental Flooring Company
Christopher Coleman
9319 N. 94th Way, Suite 1000
Scottsdale, AZ. 85250

Dear Christopher Coleman,

1GPA is pleased to announce that Continental Flooring Company has been awarded a contract for the following services based on the proposal submitted to 1GPA for IFB # 16-01S:

Commodity/Contract Title:

Flooring Products and Services

Contractor/Vendor:

Continental Flooring Company

Contract Number:

16-01S-01

The contract #16-01S-01 is effective immediately and will expire on December 17, 2016. The contract may be renewed annually for up to an additional four years, if mutually agreed to by 1GPA and your firm.

The 1GPA partnership can be of great help to participating agencies. Please feel free to provide copies of this letter to your sales representative to assist in their work. Please review the Vendor Welcome Guide that is included in the Award Notification Email.

If you have any questions or concerns, please feel free to contact Christy Knorr at the 1GPA office at 480/399-6366 or via email; cknorr@1GPA.org. We look forward to working with you and your team!

Sincerely,

Ken Carter

Ken Carter
1GPA, Executive Director

1910 W. Washington St. * Phoenix, AZ. 85009

www.1GPA.org

BID AND CONTRACT ACCEPTANCE

The Undersigned hereby certifies understanding and compliance with the requirements in the General Terms and Conditions. Bidder further agrees to furnish the material and/or service in compliance with all terms, conditions, specifications, and amendments in the solicitation and any written exceptions in the Bid (If Applicable)

State Transaction (Sales) Privilege Tax License No.: 07-218995-J

Federal Employer Identification Number 85-0369902

Company Name CONTINENTAL FLOORING COMPANY

Address 9319 N. 94TH WAY, SUITE 1000 City SCOTTSDALE State AZ Zip 85250

Telephone Number (480) 949-8509 Fax (480) 945-2603

Printed Name CHRISTOPHER L. COLEMAN Title PRESIDENT

Primary Email ccoleman@continentalflooring.com Company Email info@continentalflooring.com

Authorized Signature 

The Contractor shall not to commence any billable work or to provide any material or service under this contract until Contractor receives purchase order from a 1GPA member.

1GPA BID AND CONTRACT ACCEPTANCE

The Bid is hereby accepted:

The Contractor is now bound to sell the materials and/or services offered to and accepted by 1GPA in accordance with the solicitation, including all terms, conditions, specifications, amendments, etc.

This contract shall henceforth be referred to as Contract Number 16-01S Flooring Products and Services

Awarded this 17th day of December 2015

This contract shall be effective this 17th day of December 2015

1GPA

Signature:  Date: 12/17/15

Title: Executive Director

Printed Name: Ken Carter

Approved By: Scottsdale Unified School District

Signature:  Date: 12/17/15

Title: Director Purchasing

Printed Name: Mike Romanoff



**Determination for Multiple Award
Flooring Products & Services
RFP 16-01S**

In accordance with the requirements of A.A.C. R7-2-1031, IGPA may make a multiple award if the invitation for bids included notification that multiple contracts may be awarded, the basis for determining whether to award multiple contracts, and the criteria for selecting vendors for the multiple contracts. A multiple award shall only be made if IGPA determines in writing that a multiple award is necessary and is advantageous to IGPA and its Members and establishes procedures for the use of the multiple awarded contracts to ensure that purchases are made from the contracts determined by IGPA to offer the lowest cost in satisfying the school district's requirements. A multiple award shall be limited to the least number of suppliers necessary to satisfy the requirements of IGPA and its Members.

The basis for determining whether to award a multiple contract, as stated in the IFB, is based on the large number and variety of potential using districts and agencies eligible to participate in the resultant contract. In order to assure that any ensuing contracts will allow IGPA to fulfill current and future requirements; IGPA reserves the right to award contracts to multiple vendors.

- The decision is based upon consideration of the complex scope of work for the various products and installation/ miscellaneous services and bidder(s)' ability to fulfill the needs of members in its entirety. The scope of work ranges from resilient flooring, ceramic and tile, playground surfacing, wood, vinyl, in addition to complex installation and services for the broad range of products covered under the contract.
- Contractor's ability to provide for a large diverse Membership and geographic areas served will be considered when determining the need for a multiple award. Regional Pricing was requested in the invitation for bids for the purpose of evaluating and awarding by regions. For members outside of the Greater Phoenix region, 3 bidders service the entire State of Arizona. For Members outside of Arizona, 2 bidders are able to provide flooring products and services, however, only 1 bidder is able to provide products and services Nationally to all 50 States.
- Contracts may be awarded by individual line item or groups of line items. Each bidder recommended for award provides products or services at the lowest cost under the contract for specific products and services. In reviewing pricing submitted by all bidders line by line, there is not a single bidder that provides the lowest cost for all products and services across the board.
- A multiple award is in the best interests of IGPA and its Members in order to meet the variety of needs for Flooring Products and Services. The needs under this contract vary depending on the requirements and of each end-user such as the type of products, brands offered, and services needed.

Based upon these factors, IGPA has determined the necessity of a multiple award for **Flooring Products and Services**. The contract award recommendation is to the least number of suppliers necessary to meet the needs of IGPA members. A single award is not advantageous to IGPA members for the reasons listed above.

IFB 16-01S
Solicitation No.

Flooring Products and Services
Name of Solicitation

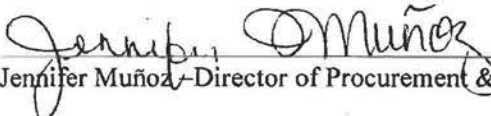
Jennifer Muñoz, Director of Procurement & Compliance

December 14, 2015
Date

CITY OF NOVI				
FOUR CORNERS CENTER FLOORING				
			<i>Unit</i>	<i>Total</i>
<i>Description</i>	<i>Quantity</i>	<i>Unit</i>	<i>Cost</i>	<i>Cost</i>
1GPA ITEMS				
Remove existing VCT	8640	SF	\$ 0.81	\$ 6,998.40
Scrape existing adhesive	8640	SF	\$ 0.37	\$ 3,196.80
Floor Preparation	8640	SF	\$ 0.34	\$ 2,937.60
Provide Armstrong Stonetex VCT	192	CTN	\$ 49.50	\$ 9,504.00
Provide Armstrong S-515 Adhesive	8	PAILS	\$ 39.01	\$ 312.08
Install VCT	8640	SF	\$ 1.15	\$ 9,936.00
OPEN MARKET ITEMS				
Provide and Install Transitions	72	LF	\$ 3.50	\$ 252.00
Moisture Tests	10	EA	\$ 40.00	\$ 400.00
Cut Tight to Existing Base and Caulk	360	LF	\$ 0.60	\$ 216.00
Storage Container	1	EA	\$ 300.00	\$ 250.00
Material Freight	1	LS	\$ 350.00	\$ 327.12
QUOTE TOTAL				\$ 34,330.00

PRODUCT SPEC PAGE

STANDARD EXCELON® Imperial® Texture | MultiColor™ Vinyl Composition Tile (VCT)

Product Information

Construction	Product Line	International Product Specifications	Overall Thickness Wear Layer Thickness	Factory Finish	Installation	Maintenance Options
Vinyl Composition Tile	Imperial Texture MultiColor	ASTM F1066 - Class 2 Through Pattern ISO 10595 Type II	1/8 in. (3.2 mm)	Fast Start®	Full Spread Adhesives S-315, S-525, S-700, S-750 & S-240, Flo™ Spray Adhesive	Polish

Packaging

Tile Size	Tile per Carton/Coverage	Shipping Weight per Carton
12 in. x 12 in. (305 mm x 305 mm)	45 - 45 ft ² (4.18 m ²)	Approx. 63 lbs./carton (28.6 kg)

Product Structure

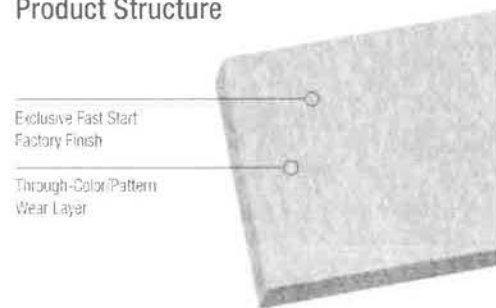

Testing

	Performance	Test Method	Requirement	Performance vs. Requirement
ASTM F 1066	Thickness	ASTM F 336	Nominal ± 0.005 in.	Meets
	Size	ASTM F 2055	± 0.016 in. per linear foot	Meets
	Squareness	ASTM F 2055	0.010 in. max.	Meets
	Indentation - One Minute	ASTM F 1914	≤ 0.006 in. to ± 0.015 in.	Meets
	Indentation @ 115°F	ASTM F 1914	≤ 0.032 in.	Meets
	Impact	ASTM F 1265	No cracks beyond limit	Meets
	Wear (100)	ASTM F 1334	1.0 in. minimum	Meets
	Dimensional Stability	ASTM F 2199	≤ 0.024 in. per linear foot	Meets
	Chemical Resistance	ASTM F 425	No more than slight change in surface dulling, attack or staining	Meets
	Resistance to Heat	ASTM F 1514	ΔE not greater than 3.0	Meets
Additional	Static Load Resistance	ASTM F 970	≤ 0.005 in.	125 psi
	Fire Test Data - Flame Spread	ASTM E 648	0.45 W/cm ² or more Class I	Meets
	Fire Test Data - Smoke Evolution	ASTM E 662	450 or less	Meets
	Fire Test Data - Canada	CANULC S102-2	Use dependent	Flame Spread - 0 Smoke Developed - 30

PRODUCT SPEC PAGE

STANDARD EXCELON® Imperial® Texture | MultiColor™ Vinyl Composition Tile (VCT)

Maritime Usage

IMO Resolution A653 (16) Surface Flammability IMO MSC 61(67) Annex 1 Part 5 and Annex 2 Smoke and Toxicity IMO MSC 61(67) Annex 1 Part 2 and Annex 2	Passes Passes
Safety Of Life at Sea (SOLAS)	Compliant
United States Coast Guard	Approved

Sustainability

Certification Attribute	Standard	3rd party Certification/Certifier	
Low-Emitting Material	CDPH v1.1 (2017) aka CHPS 01350	FloorScore/SCS	
Environmental Product Declaration (EPD)	ISO 14025	Yes/ASTM International	
Plant Quality	ISO 9001	Yes/SAI Global	

Performance	Standard	Requirement	Performance vs. Requirements
TVOC Range	CDPH v1.1 (2017) aka CHPS 01350	<0.5 mg/m ³	Meets
Low-Emitting Adhesives S-515 S-525 S-700 S-750 S-240 Flip® Spray Adhesive*	SCAQMD Rule #1169	Less than 50 g/L	S-515 Exceeds – 0 g/L S-525 Exceeds – 16 g/L S-700 Exceeds – 0 g/L S-750 Exceeds – 3 g/L S-240 Exceeds – 10 g/L Flip® Exceeds – 0 g/L
Material Ingredients (Cobion®)	LEED v4	Content disclosure to 1000 ppm	Meets (See Armstrong Product Declaration)
Recycled Content	ISO 14021	Contains recycled content	Meets - 18% Pre-Consumer

* Flip® Spray Adhesive is Cradle to Cradle Silver certified.

Limited Warranty

5-year Commercial Warranty when installed in accordance with Armstrong's Guaranteed Installation Systems manual, F-5061.

Links

Installation Instructions	www.ArmstrongFlooring.com/usa/usa/downloads
Maintenance Information	www.ArmstrongFlooring.com/usa/usa/downloads
View the Full Line	www.ArmstrongFlooring.com/usa/usa/products
Product Transparency	www.ArmstrongFlooring.com/transparency
Email Techline	usa@armstrongflooring.com
Visit Floor Expert	www.floorexpert.com



N 42 43' 39" ♦ W 82 41' 81"

Quotation

Date: February 22, 2017

To: Novi

Attn Brandon

Project: install new lights in the 4 meeting halls

In accordance with your request we are pleased to quote the electrical installation required for the above referenced project as follows:

2 new dimmers included
113 new 2x2 led fixtures with dimming
All associated wire and fittings included

Total Price \$38,738.51.

Thank you for the opportunity. If you require additional information please do not hesitate to contact me.

Sincerely,
Alan Thueme
Purchasing agent
Great Lakes Power & Lighting, Inc.
E-mail: athueme@greatlakespwr.com
Cell Ph: 586-855-0960

Metalux

DESCRIPTION

The FR series is a premium recessed commercial luminaire which offers a high quality lighting solution dedicated with the latest solid state lighting and electronic driver technology for optimal performance and energy efficiency. The FR series is compatible with all of today's popular ceiling systems and is available with a number of shielding options and accessories for application versatility.

The FR series features efficiency, quality and performance. The series is an excellent choice for commercial office spaces, schools, hospitals or retail merchandising areas.

Catalog #		Type
Project		
Comments		Date
Prepared by		

SPECIFICATION FEATURES

Construction

Rigid housing is die formed of code gauge prime cold rolled steel and features full length die-formed stiffeners and unibody endplate for added strength. Side flanges are hemmed. Innovative design provides superior lens brightness uniformity and visual comfort. Unibody endplates are securely attached with interlocking tabs and screws. Four auxiliary fixture end suspension points provided. Gridlock feature for safety and convenience.

Controls

The FR series is equipped standard with a 0-10V continuous dimming driver that works with any standard 0-10V control/dimmer. Combine with energy-saving products like occupancy sensors, daylighting controls, and lighting relay panels from Cooper Controls (www.coopercontrol.com) to maximize energy savings. Or, specify the Digital Addressable Lighting Interface (DALI) drivers, dimmable down to 1% with the HD option, for use with Fifth Light controls. Consult factory for integrated sensor options.

Electrical

Long-Life LED system coupled with electrical driver to deliver optimal performance. LED's available in 2700, 3000K, 3500K, 4000K or 5000K with typical CRI 85. Projected life is 60,000 hours at 70% lumen output. cULus listed. Electronic drivers are available for 120-277V applications. A 0-10V dimming driver is standard.

Emergency Battery Pack Option

Optional 120v-277v integral emergency battery pack is available in 7-watts or 14-watts to meet critical life-safety lighting requirements. The 90-minute batteries provide constant power to the LED system, ensuring code-compliance. A test switch/indicator button can be tested safely from the ground using a laser pointer, while the patented EZ Key prevents accidental discharge of the battery during construction. See ordering information for details.

Finish

Multistage, iron phosphate pretreatment ensures maximum bonding and rust inhibition. Housing and driver cover finished with new 90% reflective white enamel for superior performance.

Hinging / Latching

Cam steel latches with baked white enamel finish. Safety-lock T-hinges allow hinging and latching either side.

Frame/Optical Shielding

Curved, Frost lens within steel hinged door frame. Lens offers a balance of aesthetics and light stability.

Compliance

Modules are UL recognized components and indoor luminaires are cULus listed for 25°C ambient environments, RoHS compliant, and LED modules comply with IESNA LM-79 and LM-80 standards. DesignLights Consortium™ Qualified and classified for both DLC Standard and DLC Premium, refer to www.designlights.org for details.



22FR LED

2' X 2' LED LUMINAIRE

Premium Recessed Commercial LED Luminaire

For Use in Insulated Ceilings

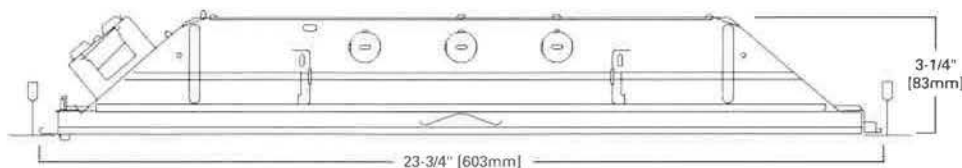

MOUNTING DATA

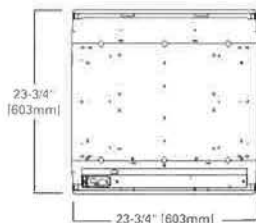

CEILING COMPATIBILITY

G	G	G	Ceiling Type	Trim Type
Grid/Lay-in Standard	Concealed T	Slot Grid	Exposed Grid	G
			Concealed T	G
			Slot Grid	G

(Verify compatibility/ consult factory.)

ORDERING INFORMATION

SAMPLE NUMBER: 22FR-LD4-32-UNV-L835-CD1-U

Rating [Blank]= Standard ATW-SW4= Chicago Rated	LED Type LD4=LED 4.0	Voltage ⁽²⁾ 347=347V UNV=Universal Voltage 120-277	Driver Type CD=0-10V Dimming Driver (10% - 100% Dimming) HCD=0-10V Dimming Driver (1% - 100% Dimming) SD=Step-dim Driver ⁽³⁾ 5LTD=Fifth Light DALI Driver (10% - 100% Dimming) ⁽⁴⁾ ⁽⁵⁾ 5LTHD=Fifth Light DALI Driver (1% - 100% Dimming) ⁽⁴⁾ ⁽⁵⁾	Options PMW=Paint Matte White
Width / Length 22=2' x 2'	LED Lumens Output ⁽⁴⁾ Stock 32=3200 MTQ 24=2400	Options Emergency EL7W=7-watt, 120V-277V emergency battery pack installed ⁽²⁾ EL14W=14-watt 120V-277V emergency battery pack installed ⁽²⁾ GTD2=Bodine Generator Transfer Device ⁽⁷⁾ ETS2=IOTA Emergency Transfer Switch ⁽⁷⁾	Number of Drivers 1=1 Driver	Packaging U=Unit Pack
Series ⁽⁸⁾ FR=Premium Commercial Luminaire	Shielding [Blank]=Curved Frosted Acrylic Lens (standard) HP=High Performance, Curved Frosted Acrylic Lens	CCT L827=2700K L830=3000K L835=3500K L840=4000K L850=5000K Flex Multiple Configurations Available	ACCESSORIES EQ-CLIP-U=T-BAR Safety Earthquake Clips ⁽¹⁾ DF-22-W=2' x 2' Drywall Frame Kit SK-22-WS=2' x 2' Shallow Surface Mount Kit SK-22-WT=2' x 2' Tall Surface Mount Kit DF10P-C=Decorator Dimmer, 0-10V SF10P=Decorator Slide Dimmer, 0-10V ISHH-01=Programming Remote for Integrated Sensor ISHH-02=Personal Control Remote for Integrated Sensor	
Door Frame Standard=Flat White Steel Door (Leave Blank)				

NOTES: ⁽¹⁾An EQ Grid Clip is recommended for all 9/16" ceiling systems. Four required per fixture. ⁽²⁾Products also available in non-US voltages and frequencies for international markets. ⁽³⁾External test switch / indicator / laser test. For approximate delivered lumens multiply the lumens per watt of the desired fixture by the wattage of the emergency battery pack (100 lm/W x 7=700 lumens). IES-format photometry for luminaire under emergency operation available. ⁽⁴⁾Nominal lumen output. ⁽⁵⁾Step-Dim (Bi-Level) and Fifth Light (DALI) only available for 3,200 lumen. ⁽⁶⁾Must be used in conjunction with a DALI control system. For complete DALI solutions by Fifth Light, visit www.eaton.com/lightingsystems. ⁽⁷⁾Used to transfer fixture to secondary power source for life-safety operation. When used with a dimming fixture, two devices are required to ensure control is disabled while operating under emergency power. ⁽⁸⁾DesignLights Consortium™ Qualified and classified for both DLC Standard and DLC Premium, refer to www.designlights.org for details.

Specifications & dimensions subject to change without notice. Consult your Eaton Representative for availability and ordering information.

SHIPPING DATA

Catalog No.	Wt.	Pallet
22FR-LD4	10 lbs.	48